

# City of Mobile Twelve Mile Creek

- Intermediate Contour
- Primary & Secondary Contour
- Building
- Building (not to scale)
- Parcels
- Water
- Stream
- Drainage Easement

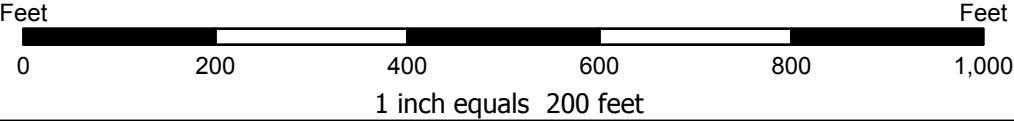

**City of Mobile**  
**Geographic Info. Systems Dept.**  
205 Government Street, 4th FL S  
P.O. Box 1827 (36633-1827)  
Mobile, Alabama 36644  
(251) 208-7943  
<http://maps.cityofmobile.org>  
Date Printed 1/22/2018

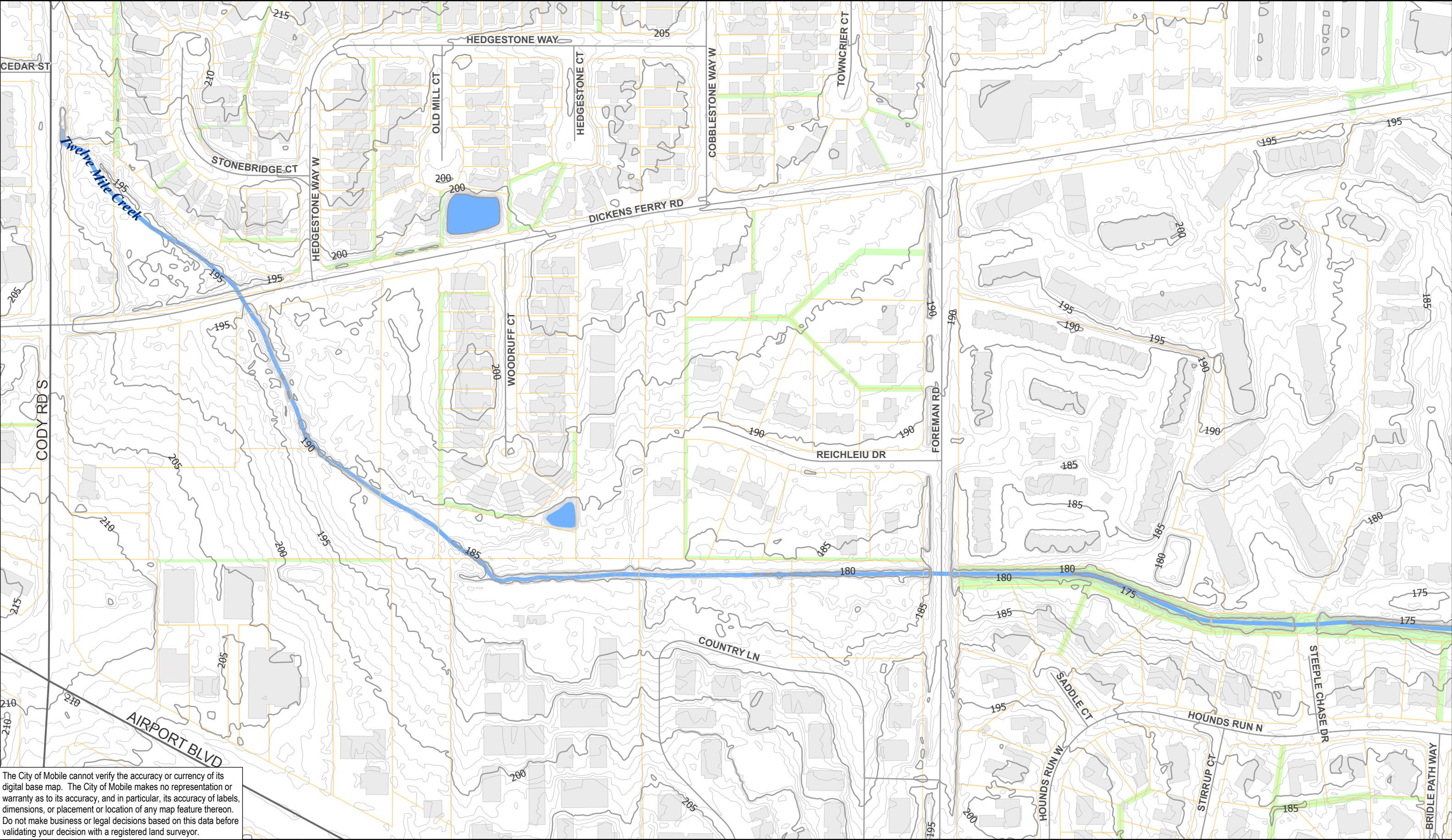

The City of Mobile cannot verify the accuracy or currency of its digital base map. The City of Mobile makes no representation or warranty as to its accuracy, and in particular, its accuracy of labels, dimensions, or placement or location of any map feature thereon. Do not make business or legal decisions based on this data before validating your decision with a registered land surveyor.



# City of Mobile Twelve Mile Creek

- Intermediate Contour
- Primary & Secondary Contour
- Building
- Building (not to scale)
- Parcels
- Water
- Stream
- Drainage Easement

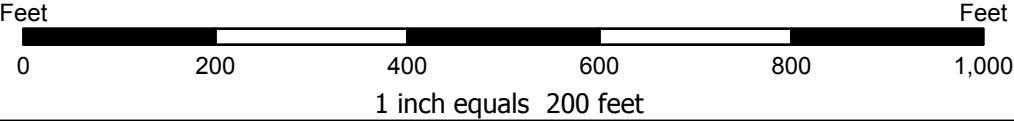

**City of Mobile**  
**Geographic Info. Systems Dept.**  
205 Government Street, 4th FL S  
P.O. Box 1827 (36633-1827)  
Mobile, Alabama 36644  
(251) 208-7943  
<http://maps.cityofmobile.org>  
Date Printed 1/22/2018

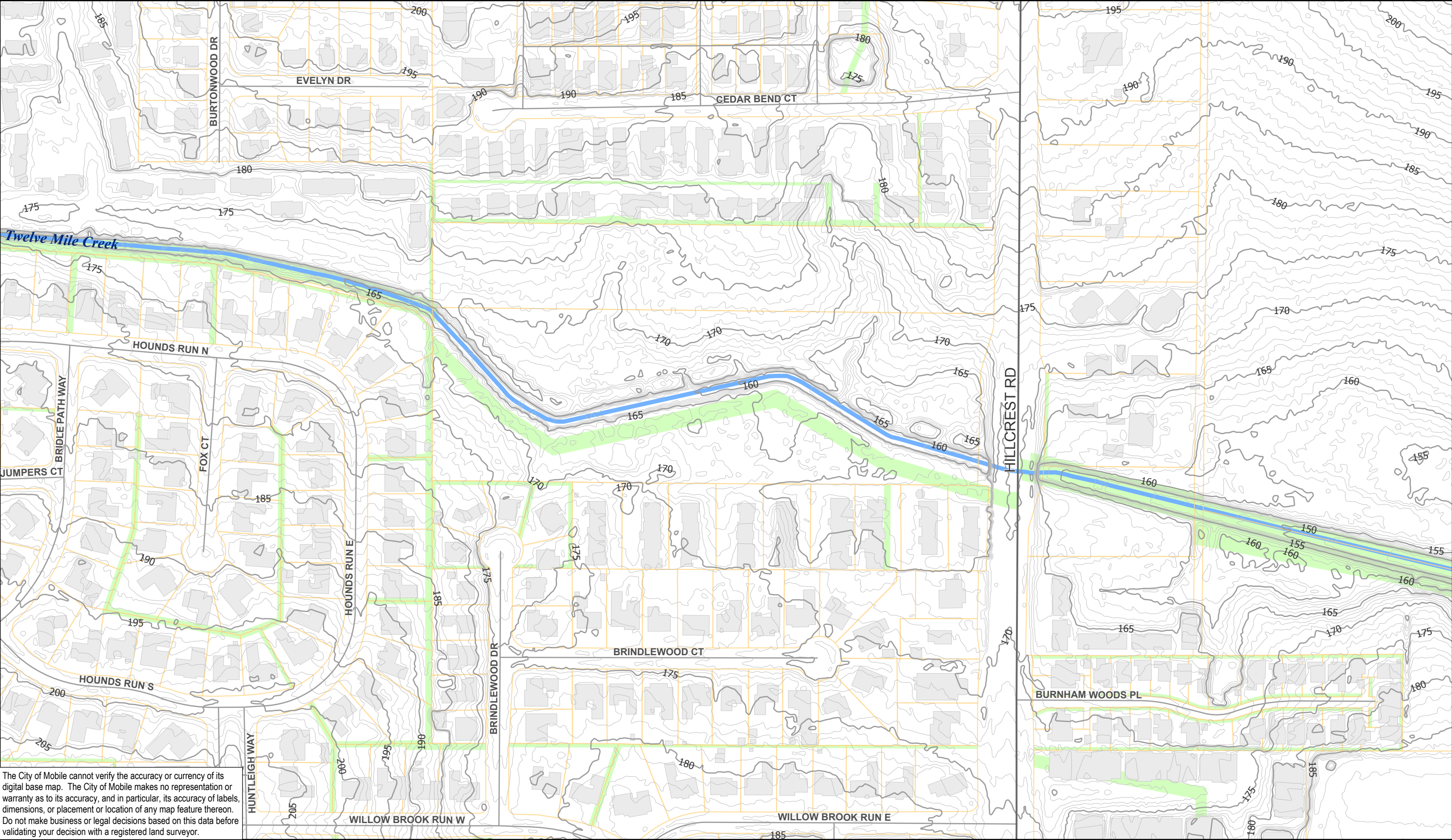

The City of Mobile cannot verify the accuracy or currency of its digital base map. The City of Mobile makes no representation or warranty as to its accuracy, and in particular, its accuracy of labels, dimensions, or placement or location of any map feature thereon. Do not make business or legal decisions based on this data before validating your decision with a registered land surveyor.



City of Mobile  
Twelve Mile Creek

- Intermediate Contour
- Primary & Secondary Contour
- Building
- Building (not to scale)
- Parcels
- Water
- Stream
- Drainage Easement

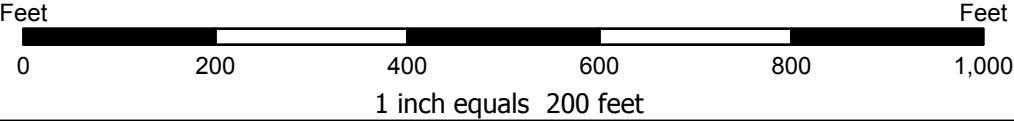

**City of Mobile**  
**Geographic Info. Systems Dept.**  
205 Government Street, 4th FL S  
P.O. Box 1827 (36633-1827)  
Mobile, Alabama 36644  
(251) 208-7943  
<http://maps.cityofmobile.org>  
Date Printed 1/22/2018

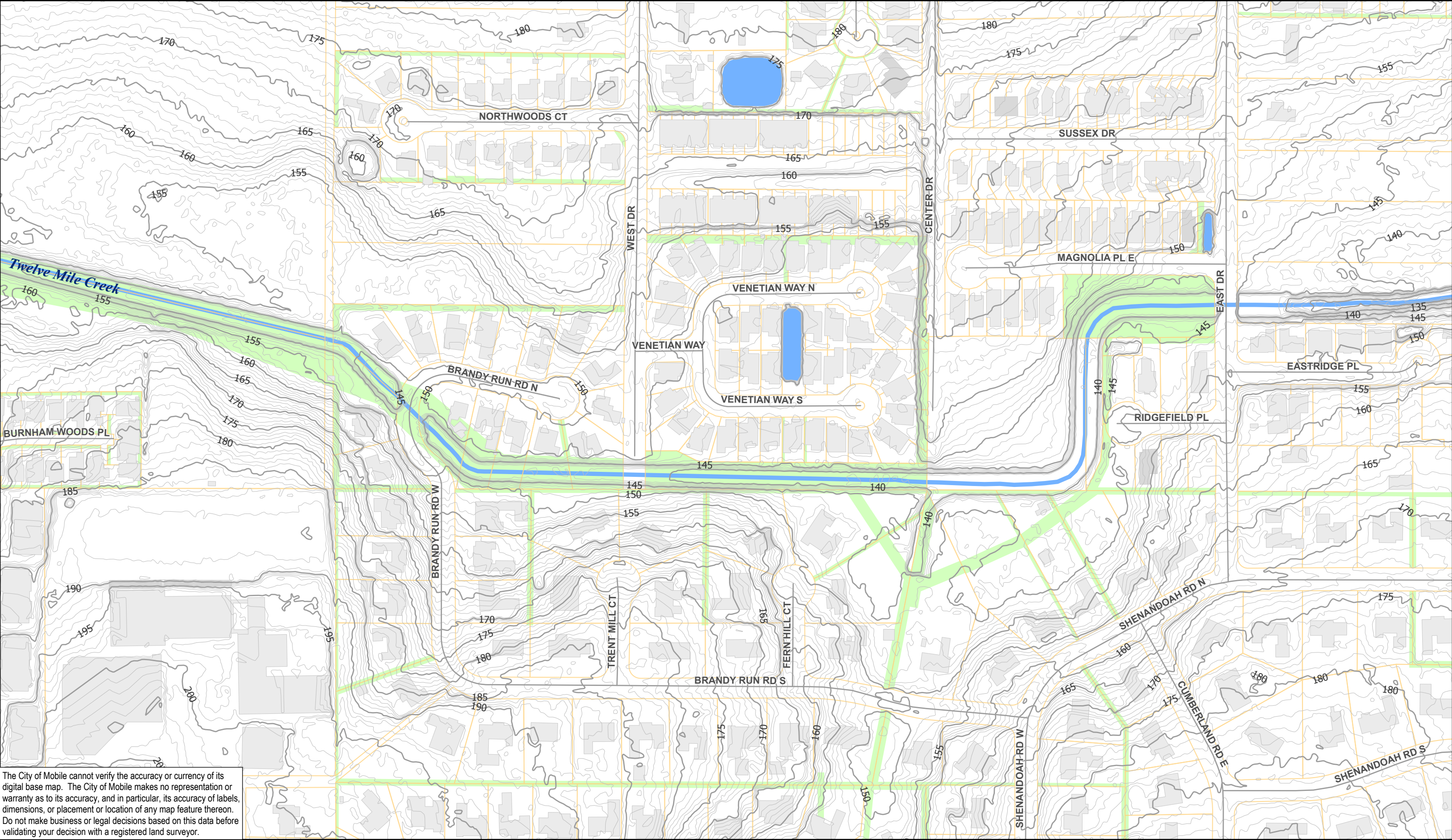

The City of Mobile cannot verify the accuracy or currency of its digital base map. The City of Mobile makes no representation or warranty as to its accuracy, and in particular, its accuracy of labels, dimensions, or placement or location of any map feature thereon. Do not make business or legal decisions based on this data before validating your decision with a registered land surveyor.